

10 TIPS

FOR MAINTAINING YOUR NUAIRE DIRECT HEAT CO₂ INCUBATOR

Regular preventive maintenance on your incubator helps to maintain proper growth conditions and prevent contamination.

1 CLEAN INTERIOR & EXTERIOR

Exterior: Mild detergent and single distilled water.
Interior: Chloride-free disinfectant for chamber, water pan, inner door, and gasket.

Shelves, guide rails, and door gaskets may be removed for sterilization.



Before cleaning or decontamination remove cultures to a safe location.



Remove the RH sensor from the chamber before the cycle. Wipe interior to remove moisture, debris, or spills before the cycle. Allow 8 hours for the 145°C dry decontamination cycle. Recalibrate the temperature sensor after the cycle.

3 CHECK GAS SUPPLY PRESSURE

Ensure that medical grade CO₂ and N₂ is supplied via a two-stage regulator at a pressure of 20 PSIG / 1.4 BAR but not above 25 PSIG / 1.8 BAR. Inspect at least every 6 months.

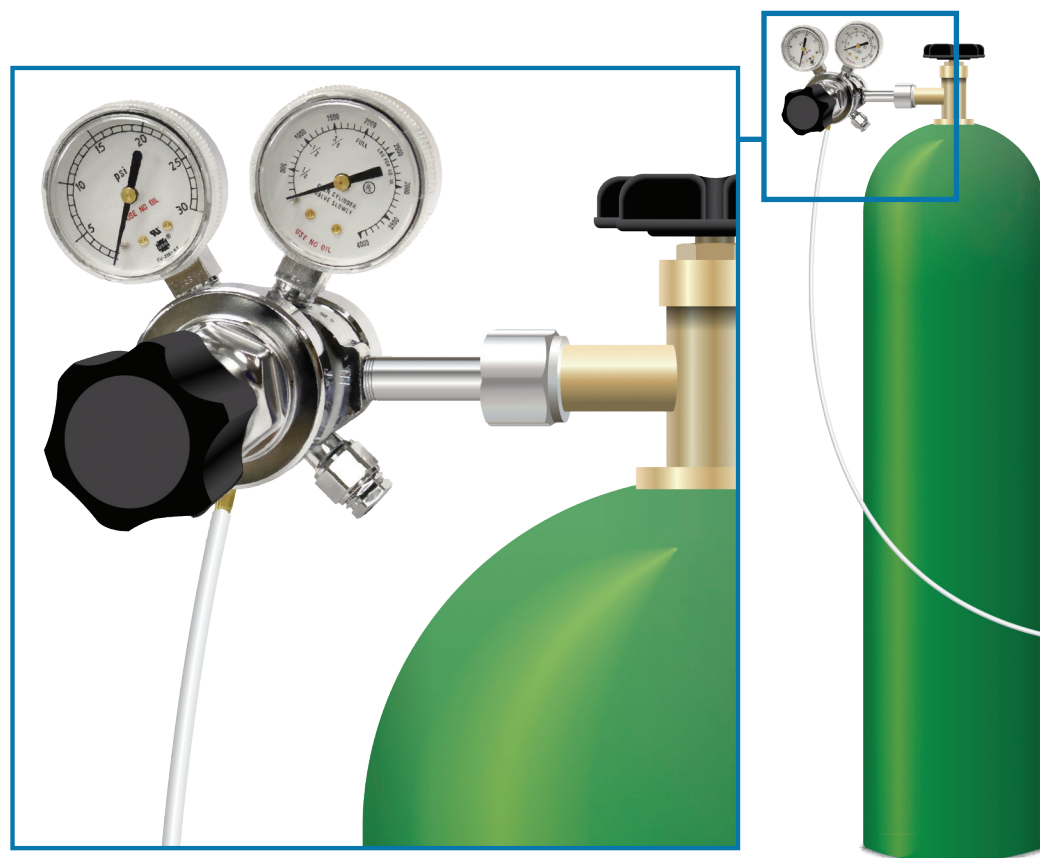

4 CHECK INTEGRITY OF HOSE CONNECTIONS

Apply soapy water to hose connections. Bubbles indicate leaks.

Inspect at least every six months.

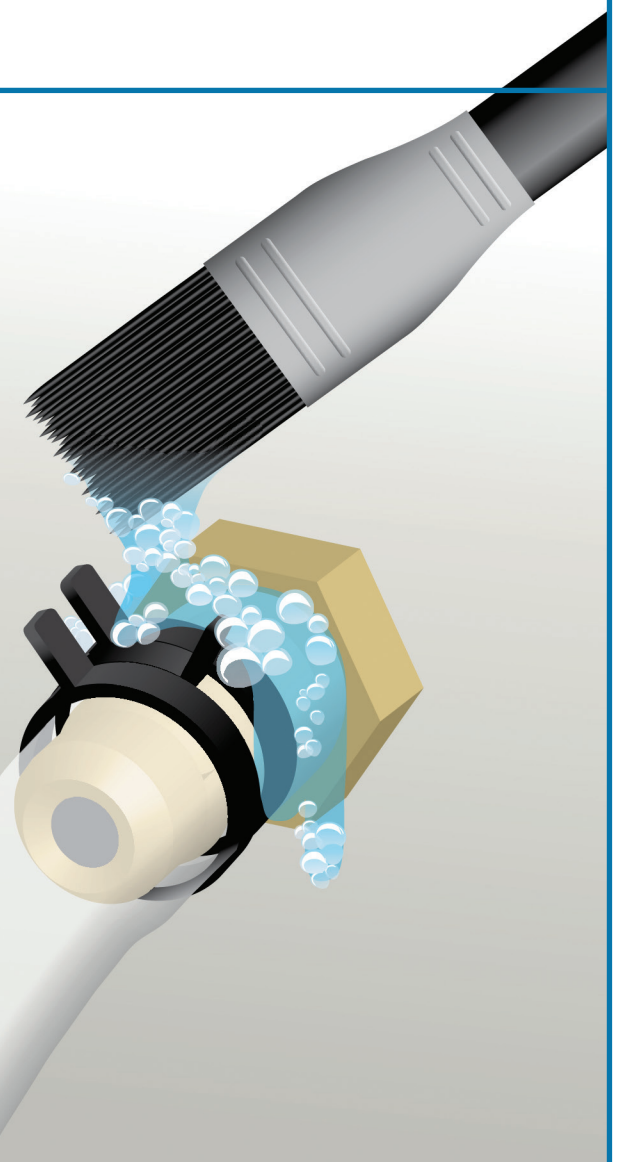

5 CHANGE EXTERNAL DISK FILTERS FOR GAS & AIR SUPPLY

Check the CO₂, N₂ and air disk filters located behind the bottom, front valence. Replace when filters are visibly discolored or after every fifth tank of CO₂ is consumed.

Inspect each filter at least every six months.

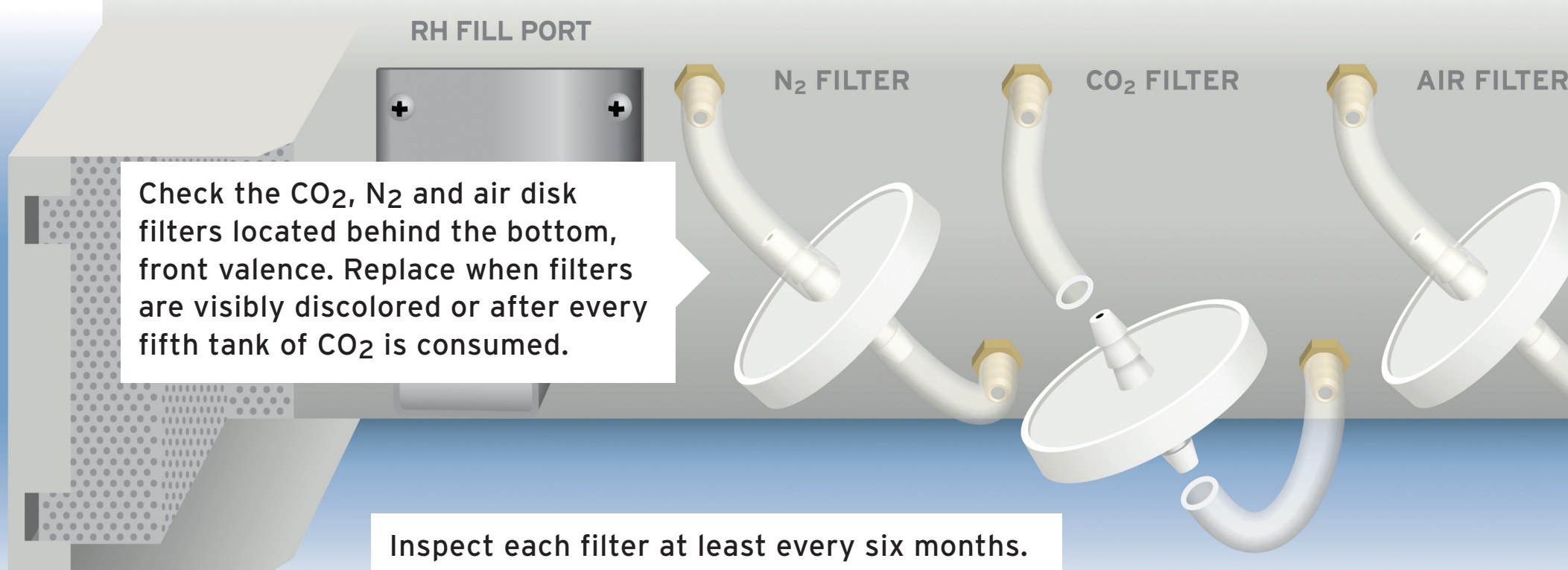

6 CHANGE CAPSULE HEPA AND WET DISK FILTER IN THE SENSOR BAY

Check the capsule HEPA filter inside the sensor bay. Replace it when discolored or after four years of use.

Check the wet disk filter in the sensor bay. Replace it when discolored.

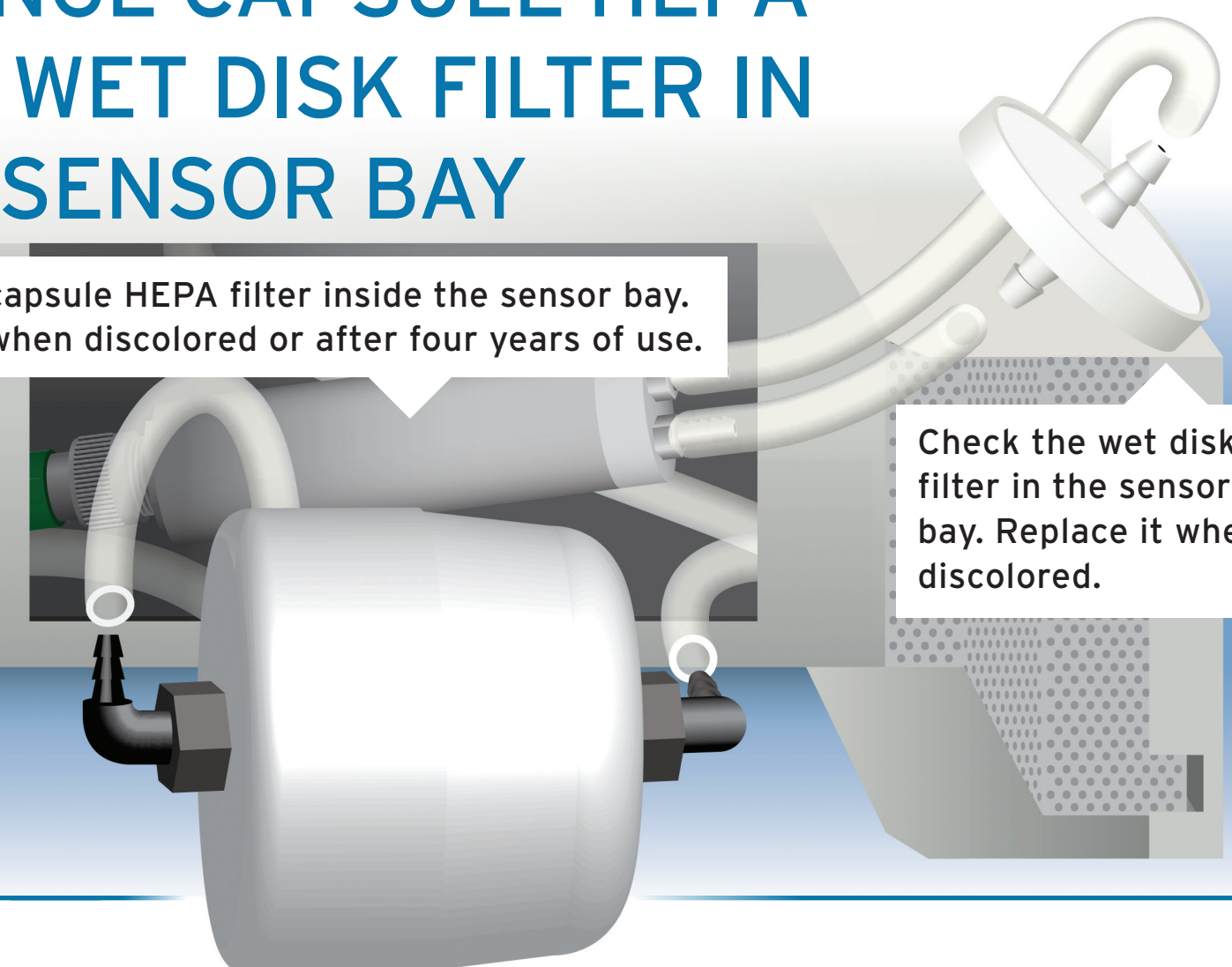

7 CHECK INTEGRITY OF DOOR SEALS

Ensure that gaskets for the inner and outer doors are both free of cracks and other wear.



8 REFILL WATER PAN OR RESERVOIR

Refill the reservoir when the on-screen notification appears.

Note: Use single-distilled water no purer than one mega-ohm for the pan or reservoir.

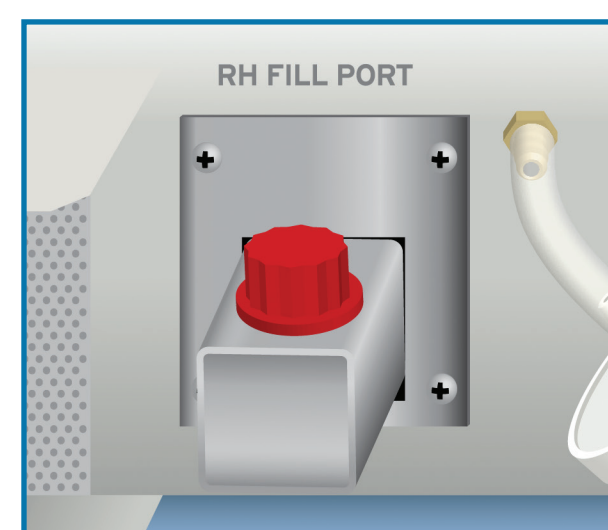

Refill the water pan every week.



9 CALIBRATE TEMPERATURE, CO₂, RH AND O₂ SENSORS

Calibrate at least every six months. Always calibrate after filter changes, gas supply pressure corrections, or gas supply tubing repairs.

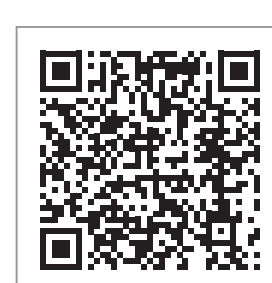
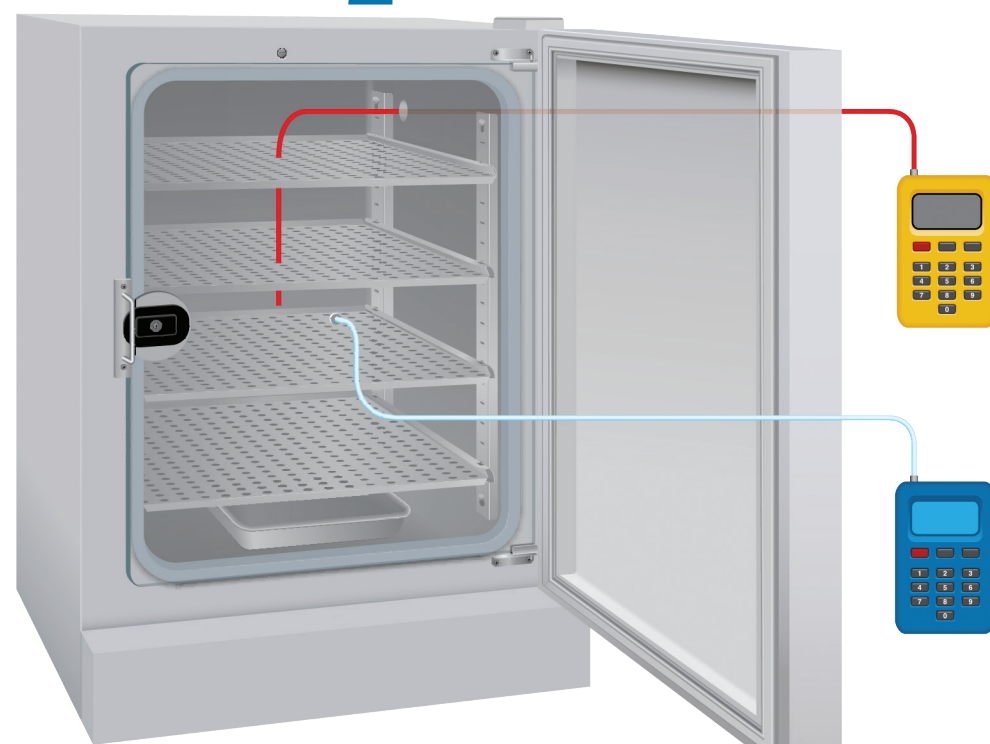

Scan for more info about water-jacketed CO₂ incubators.

10 CHECK FOR CONDENSATION

Consult your service manual to adjust the door and/or perimeter heaters to eliminate excess condensation. If condensation persists, contact Service for guidance in adjusting chamber air injections. Inspect at least every six months.

